

SERIES 3000

Interchangeable with
Parker Commercial
30 and 31 Series

ATEX^{Ex} assessed
Baseefa 10ATEX0002DRR
IP50



DATA SHEET
R3000

Roller Bearing Gear Pumps, Motors and Flow Dividers

- Single or multiple units available.
- Piggy back options available.
- Type II mounting available.
- Displacement 16 cc/rev to 82 cc/rev.
- Minimum operating speed 600 rpm.
- Maximum operating speed 2400 rpm.
- Maximum continuous operating pressure 3000 psi (207 bar). *1
- Cast iron construction.
- Dowelled units available.

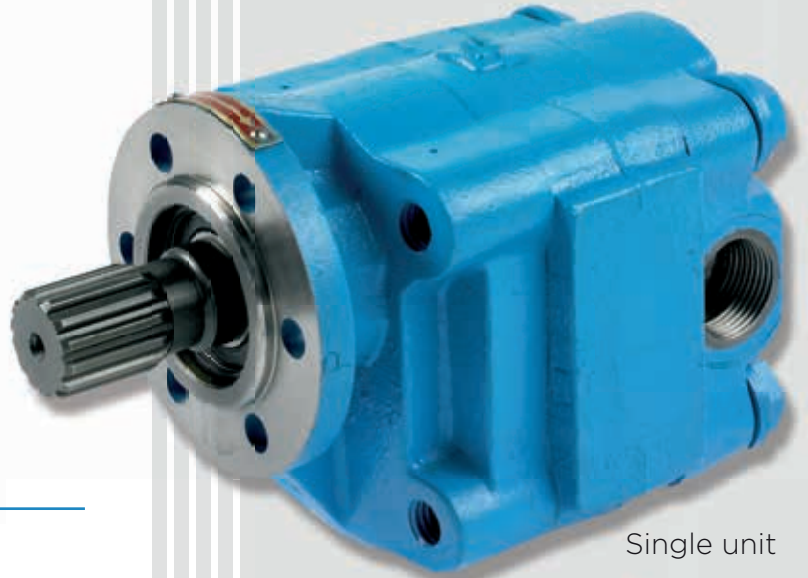

Single unit

Mounting Flange Options:

SAE 'A' 2 bolt, SAE 'B' 2 bolt, SAE 'B' 4 bolt, SAE 'C' 4 bolt, 6 bolt round, pad mount.

Drive Shaft Options:

SAE 'A' 9 tooth, SAE 'B' 13 tooth, SAE 'BB' 15 tooth, SAE 'C' 14 tooth, SAE 'B' keyed, SAE 'BB' keyed, SAE 'C' keyed, 1.1/8" keyed, 3/4" keyed.

Various Porting Options:

BSP, SAE, NPT, JIC (ODT).

*1 Only available in 16, 25, 32 and 41cc.

Performance and Dimensions overleaf



Tandem unit

Recommended Operating Conditions:

Fluid viscosity, normal operating conditions
16 to 220 cst.

Fluid temperature should not exceed 65° C

Recommended system oil cleanliness should
be equal to or better than ISO4406 19/17/14.

Inlet pressure; for best operation with
mineral oil, pressure should not exceed minus
0.237 bar (7 in HG).



Please discuss your application with our sales engineers

Series 3000 Pumps Motors and Flow Dividers

PERFORMANCE DATA

Pump Performance

Output- L/min/igpm - Input-Kw/Horsepower ▶						Input Speed - rpm									
						1000		1500		1800					
Gear widths - code	Gear widths - inches	Displacement - cc/rev	Maximum continuous working pressure-bar/psi	Output	Input	Output	Input	Output	Input	Output	Input				
						05	1/2	16	207/3000	13 / 2.8	4 / 6	21 / 4.5	7 / 9	26 / 5.6	8 / 11
						07	3/4	25	207/3000	19 / 4.1	6 / 8	31 / 6.8	10 / 13	38 / 8.4	11 / 15
						10	1	32	207/3000	25 / 5.5	8 / 11	41 / 9.0	13 / 17	51 / 11.2	15 / 20
						12	1.1/4	41	207/3000	31 / 6.9	10 / 13	53 / 11.7	17 / 22	66 / 14.5	20 / 26
						15	1.1/2	49	180/2610	42 / 9.2	12 / 16	66 / 14.5	20 / 27	81 / 17.9	27 / 32
						17	1.3/4	57	180/2610	48 / 10.6	14 / 19	77 / 17.0	23 / 31	94 / 20.8	28 / 37
						22	2.1/4	74	155/2250	68 / 14.9	17 / 22	102 / 22.4	27 / 36	122 / 26.8	36 / 48
						25	2.1/2	82	155/2250	75 / 16.6	18 / 24	113 / 24.9	29 / 39	135 / 29.8	40 / 53

• Flows quoted are at test pressure of 138 bar/2000 psi, using 32cSt oil at 65° C.

• Dowelled units also available 3100/31.

• Performance data is derived from tests conducted to simulate working conditions. Continuous operation at maximum performance may compromise unit life.

If in doubt when specifying, please consult our sales department.

Motor Performance

				Output Speed - rpm				
				800	1200	1600	2000	
Gear widths - code	10	1	Output hp & torque	Output Kw / hp	5.5 / 7.5	8.0 / 11.0	11.0 / 14.5	13.0 / 17.5
				Output Nm / in.lb	65.0 / 575	64.0 / 570	64.0 / 565	62.5 / 555
				Input l.min / igpm	38.5 / 8.5	52.5 / 11.5	64.0 / 14.1	77.0 / 17.0
	15	1.1/2		Output Kw / hp	8.5 / 11.5	12.5 / 17.0	17.0 / 22.5	20.5 / 27.5
				Output Nm / in.lb	101.5 / 900	100.5 / 890	99.5 / 880	97.0 / 860
				Input l.min / igpm	52.0 / 11.5	73.0 / 16.0	91.0 / 20.0	111.0 / 24.5
	20	2		Output Kw / hp	11.0 / 15.0	17.0 / 22.5	21.5 / 29.0	27.0 / 36.0
				Output Nm / in.lb	133.5 / 1180	132.0 / 1170	131.0 / 1160	128.0 / 1130
				Input l.min / igpm	68.0 / 15.0	91.0 / 20.0	123.0 / 27.0	147.5 / 32.5

* These gear widths are the popular sizes for motor configurations but any of the gear widths listed in the Pump Performance table can be supplied.

Weights (approximate)

Gear widths (ins)	1/2	3/4	1	1.1/4	1.1/2	1.3/4	2	2.1/4	2.1/2
Single unit (kg)	13.5	14.0	14.5	15.0	15.5	16.0	16.5	17.0	17.5

For multiple unit weights, please consult our sales department.

Dimensions

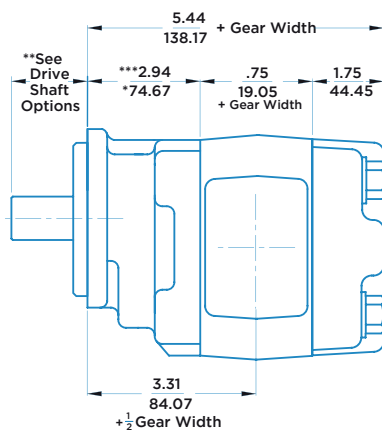

Single unit

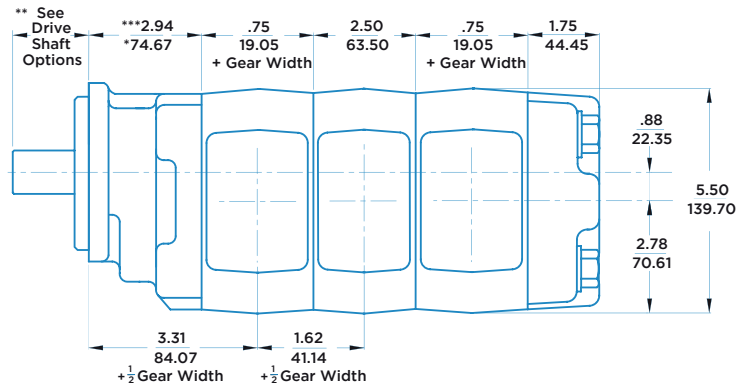

Tandem unit

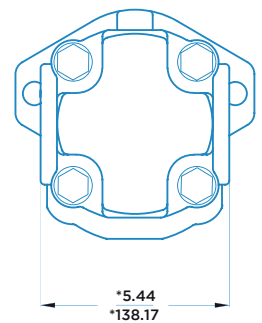

* Standard port arrangement, dimension will change with the type of port

** Dimensional information for mounting flange and shaft options are shown on the attached Data Sheet FS100.

***Dimensions for Type II mounting are *1.81 *45.97



HYDRAULIC ENGINEERS

Unit 20 Silver Court, Intercity Way, Bramley, Leeds, West Yorkshire LS13 4LY. UK.
Tel: +44 (0) 113 2361367 Email: sales@hydra-perm.co.uk web: www.hydra-perm.co.uk